



PALLOVENTTIILI

Sarja 776000, COMBI-SFER

BALL VALVE

Series 776000, COMBI-SFER



KIERTEYTETTY RUNGON LÄPI DN 15 - DN 40
TAPPED THROUGH THE BODY FROM DN 15 TO DN 40

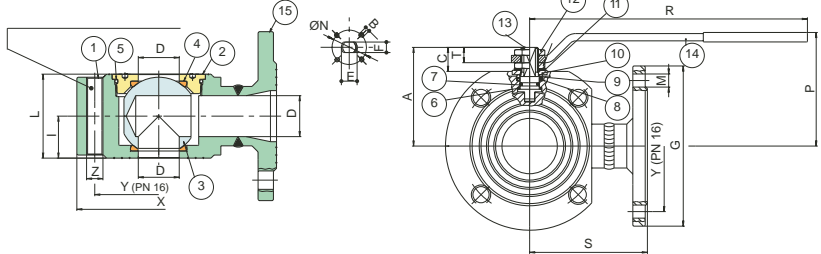

TEKNISET TIEDOT

Materiaali: hiiliteräs, (kts. taulukko)
Rakenne: 3-tie, supistettu aukko
Koko: 1/2" - 4", DN 15 - DN 100
Liitäntä: L-poraus, laip.väli/laippa
Painealue: kts. taulukko, max. PN bar
Alipaine: max. 10⁻³ torr
Lämpötila-alue: - 20... +160°C (kts. taulukko sivu 4)

Saatavana myös T-porauksella.Sarja 776001.
Erikoismateriaalit ja -mallit kysyttäessä.

TECHNICAL SPECIFICATIONS

Material: carbon steel, (see chart)
Construction: 3-way, reduced bore
Size: 1/2" - 4", DN 15 - DN 100
Ports: L-bore, flanged
Nom. pressure: see chart ,max. PN bar
Vacuum: max. 10⁻³ torr
Oper. temperature: - 20... +160°C (see chart page 4)

Available also with T-bore. serie 776001.
Special materials and models on request.

RAKENNEMATERIAALIT

| NO | NIMI | MATERIAALI | KPL |
|----|-----------------|---|-------|
| 1 | Runko | ASTM A105, hiiliteräs | 1 |
| 2 | Liitäntäyhde | ASTM A105, hiiliteräs | 1 |
| 3 | Pallo | ASTM A105, hiiliteräs | 1 |
| 4 | Pallon tiiviste | PTFE (Teflon®) | 2 |
| 5 | O-rengas | FKM (Viton®) | 1 |
| 6 | Laakerirengas | PTFE (Teflon®) | 1 |
| 7 | O-rengas | FKM (Viton®) | 1 |
| 8 | Karan tiiviste | PTFE (Teflon®) | 1 |
| 9 | Tiivisteholkki | AVP-9SMnPb36 | 1 |
| 10 | Poksin kansi | AISI 304 (DN15-DN50) UNI 7070(DN65-DN200) | 2 1 |
| 11 | Lautasjousi | UNI 3545 | 2 |
| 12 | Mutteri | UNI 5771 | 2 |
| 13 | Kara | UNI AISI 316 | 1 |
| 14 | Käsikahva | UNI 7070 | 1 |
| 15 | Laippa | ASTM A105, hiiliteräs | 1 |

MATERIALS OF CONSTRUCTION

| NO | PART NAME | MATERIALS | N° P |
|----|----------------|---|-------|
| 1 | Body | ASTM A105, carbon steel | 1 |
| 2 | End connection | ASTM A105, carbon steel | 1 |
| 3 | Ball | ASTM A105, carbon steel | 1 |
| 4 | Ball seat | PTFE (Teflon®) | 2 |
| 5 | O-ring | FKM (Viton®) | 1 |
| 6 | Thrust washer | PTFE (Teflon®) | 1 |
| 7 | O-ring | FKM (Viton®) | 1 |
| 8 | Stem seat | PTFE (Teflon®) | 1 |
| 9 | Packing gland | AVP-9SMnPb36 | 1 |
| 10 | End stop | AISI 304 (DN15-DN50) UNI 7070(DN65-DN200) | 2 1 |
| 11 | Spring washer | UNI 3545 | 2 |
| 12 | Nut | UNI 5771 | 2 |
| 13 | Stem | UNI AISI 316 | 1 |
| 14 | Handle | UNI 7070 | 1 |
| 15 | Flange | ASTM A105, carbon steel | 1 |

| | DN | X | Y | Z | I | L | R | P | A | C | T | G | M | D | S | E | F | N | B | PN | Kg | |
|--|--------|-----|-----|-----|-------|------|-----|-------|-------|-------|------|------|-----|-------|------|-----|----|----|-----|-------|----|-------|
| | 1/2" | 15 | 89 | 65 | 4xM12 | 20 | 40 | 131,5 | 64,5 | 47 | 15,5 | 9 | 95 | 4xØ14 | 10 | 76 | 10 | 7 | 32 | 4xM5 | 16 | 2,23 |
| | 3/4" | 20 | 99 | 75 | 4xM12 | 20 | 40 | 131,5 | 67 | 49,5 | 13,5 | 9 | 105 | 4xØ14 | 15 | 82 | 10 | 7 | 32 | 4xM5 | 16 | 2,86 |
| | 1" | 25 | 109 | 85 | 4xM12 | 23 | 46 | 174,5 | 79 | 59 | 18 | 12,5 | 115 | 4xØ14 | 20 | 86 | 12 | 8 | 42 | 4xM5 | 16 | 3,89 |
| | 1 1/4" | 32 | 130 | 100 | 4xM16 | 29 | 58 | 174,5 | 84 | 64 | 15,5 | 11,5 | 140 | 4xØ18 | 25 | 100 | 12 | 8 | 42 | 4xM5 | 16 | 6,21 |
| | 1 1/2" | 40 | 140 | 110 | 4xM16 | 35,5 | 71 | 250,5 | 102,5 | 78 | 24,5 | 13 | 150 | 4xØ18 | 32 | 105 | 16 | 10 | 50 | 4xM6 | 16 | 8,50 |
| | 2" | 50 | 160 | 125 | 4xM16 | 41 | 82 | 250,5 | 109 | 85 | 25 | 13,5 | 165 | 4xØ18 | 40 | 115 | 16 | 10 | 50 | 4xM6 | 16 | 12,27 |
| | 2 1/2" | 65 | 180 | 145 | 4xM16 | 53 | 106 | 321,5 | 128 | 104,5 | 28 | 18 | 185 | 4xØ18 | 50,2 | 125 | 20 | 14 | 70 | 4xM8 | 16 | 19,10 |
| | 3" | 80 | 200 | 160 | 8xM16 | 61 | 122 | 321,5 | 136,5 | 113 | 28 | 18 | 200 | 8xØ18 | 64 | 150 | 20 | 14 | 70 | 4xM8 | 16 | 24,34 |
| | 4" | 100 | 220 | 180 | 8xM16 | 76 | 152 | 381,5 | 155,5 | 136 | 34,5 | 22 | 220 | 8xØ18 | 76 | 159 | 24 | 18 | 102 | 4xM10 | 16 | 38,45 |

TAULUKKO

Paineen ja lämpötilan vaikutus riippuu valittavan venttiilin koosta (DN) ja tiivistemateriaalista.

CHARTS

The pressure and temperature rating directly depends on the type of valve chosen and on its size (DN) as well as the material used for the seal.

PAINE- JA LÄMPÖTILATAULUKKO PTFE-TIIVISTEILLE
PRESSURE - TEMPERATURE RATING FOR PTFE SEALS

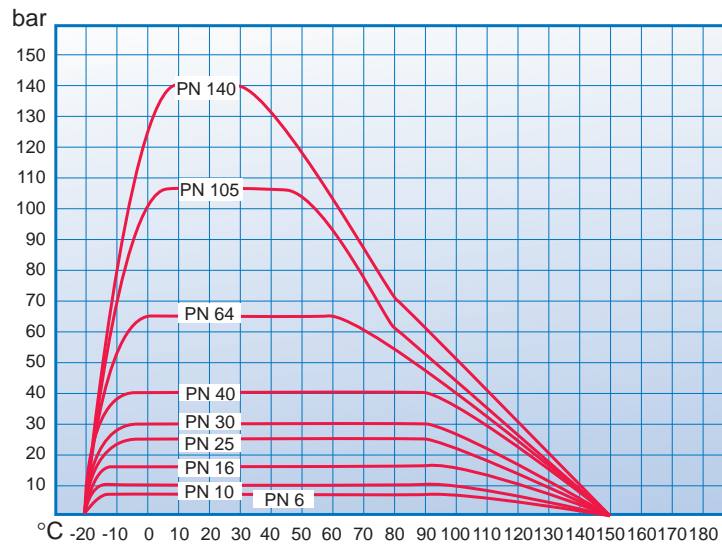

PAINE- JA LÄMPÖTILATAULUKKO
25% HIILIVAHVISTETUILLE PTFE-TIIVISTEILLE
PRESSURE - TEMPERATURE RATING FOR
25% CARBON FILLED PTFE SEALS

